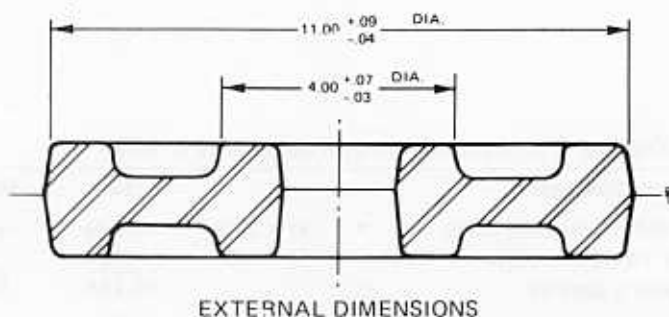

Fig. 3



METRIC CONVERSION	
INCH	mm
.03	.8
.04	1.1
.07	1.8
.09	2.3
4.00	101.6
11.00	279.4

**COMPUTATION EXTERNAL DIMENSIONS**  
MATERIAL: CARBON STEEL

EXAMPLE 5  
(SEE FIGURE 3)

Tolerance on External Dimension		Plus	Minus
INCH	Diameter x Length/Width Tolerance factor = 11 x 0.003 =	0.033	0.033
	Diameter x Die Wear Tolerance factor = 11 x 0.005 =	0.055	----
	(Table I, page 9)	+0.088	-0.033
	Raised to the next highest .01 in.	+ .09	- .04
METRIC	Diameter (mm) x Length/Width Tolerance factor = 279.4 x 0.003 =	0.839	0.839
	Diameter (mm) x Die Wear Tolerance factor = 279.4 x 0.005 =	1.397	----
	(Table I, page 9)	+2.236	-0.839
	Raised to the next highest .1 mm	+2.3	-0.9*

\*Variance due to rounding

EXAMPLE 6  
(SEE FIGURE 3)

Tolerance on External Dimension		Plus	Minus
INCH	Diameter x Length/Width Tolerance factor = 4 x 0.003 =	0.012	0.012
	Largest Diameter x Die Wear Tolerance factor = 11 x 0.005 =	0.055	----
	(Table I, page 9)	+0.067	-0.012
	Raised to the next highest .01 in.	+0.07	-0.02
Minimum Tolerance (paragraph 2, page 8)			-0.03
METRIC	Diameter x Length/Width Tolerance factor = 101.6 x 0.003 =	0.305	0.305
	Largest Diameter x Die Wear Tolerance factor = 279.4 x 0.005 =	1.397	----
	(Table I, page 9)	+1.702	-0.305
	Raised to the next highest .1 mm	+1.8	-0.3
Minimum Tolerance (paragraph 2, page 8)			-0.8